

Protecta FR Board Solid Timber or CLT Wall 100mm Metal Pipes with Continuous Non-Combustible Insulation

Installation Instructions

1. Before installing Protecta® FR Board ensure that the surface of all service penetrations and surrounding construction is free from all loose contaminants, dust and grease.
2. The FR Board may be 50mm or 60mm with coated side facing outwards.
3. Cut the required boards to suit the aperture dimensions and penetrant.
4. The FR Board must oversail the aperture by 100mm and be bonded to the wall with a bead of Protecta® FR Acrylic. Fix with 100mm wood screws and penny washers at corners and at 300mm centres 50mm in from edge.
5. All joints, gaps or imperfections in the installed seal must be filled with Protecta® FR Acrylic on both sides.
6. Protecta® FR Board can be over-painted with most emulsion or alkyd (gloss) paints.

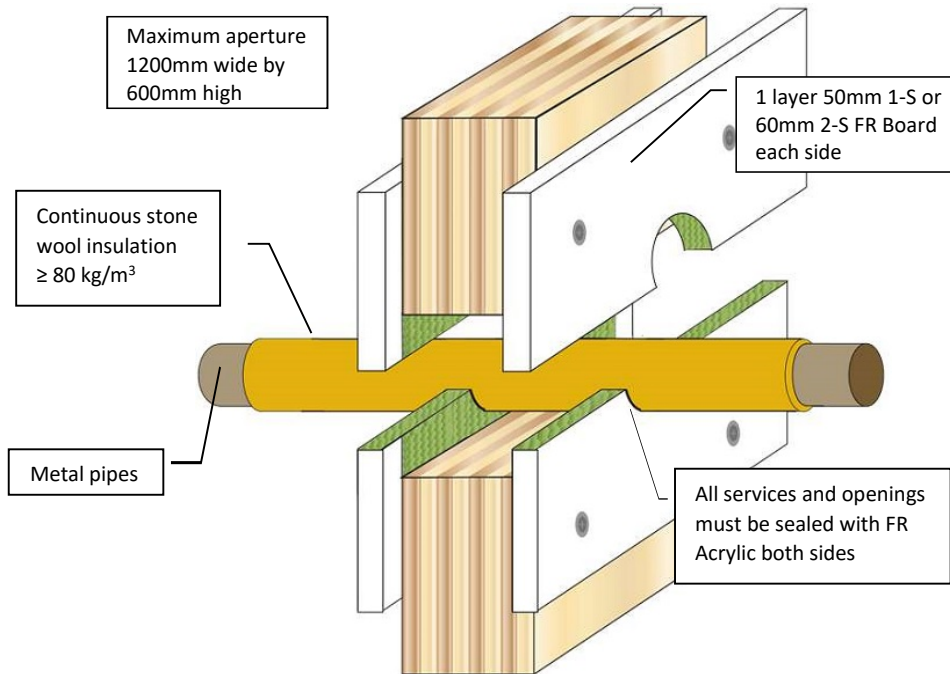

Minimum separations and limitations

An aperture can include several services, and they may also be different. Services within the system Protecta® FR Board seal do not require a minimum separation, except pipes where pipe insulation penetrates the seal and plastic pipe penetrations which should be a minimum of 30 mm from other services in the aperture. Services should be a minimum of 25mm from seal edges. The total amount of cross sections of services (including insulation) should not exceed 60% of the penetration area. The minimum permitted separation between adjacent apertures is 200mm.



As a part of our policy of on-going product development and testing, we reserve the right to modify, alter or change product specifications without giving notice. All information contained in this document is given in good faith and is provided for guidance only. Any drawings provided are for illustrative purposes only. As Polyseam has no control over the methods or competence of installation and of prevailing site conditions, no warranties, expressed or implied, is intended to be given as to the actual performance of the product mentioned or referred to herein and no liability whatsoever will be accepted for any loss, damage or injury arising from the use of the information given.

For all technical details on the products specified please refer to the technical data sheets that can be found on www.firestopcentre.co.nz

Signed and approved:

System/FPA Register ID# FC588

Products	Protecta FR Board Protecta FR Acrylic
Application	Fire stopping of insulated metal pipes in timber walls
Construction	Minimum wall thickness of 100mm and comprise solid timber or CLT with a minimum density of 510kg/m ³

Fire & Sound classification:

In 100mm walls:

Steel pipes ≤ Ø324mm with 20-80mm stone wool insulation FRR -/120/120

Copper pipes ≤ Ø54mm with 20-40mm stone wool insulation FRR -/60/60

Alupex pipes ≤ Ø75mm with 20-60mm stone wool insulation FRR -/120/90

Smoke-safe (<0.1m³/h smoke leakage at 200Pa)

Sound reduction (seal only) STC 55



Protecta®

Polyseam Ltd, 15 St Andrews Road, Huddersfield, West Yorkshire, HD1 6SB

Sheet size: A4	Drawn date & no: 20/4/21
--------------------------	-----------------------------

Scale: NTS	Drawn by: K.B
----------------------	------------------